



"The Most Trusted Name In Water"

RP2 Series

Convertible Jet Pumps

Jet Pumps

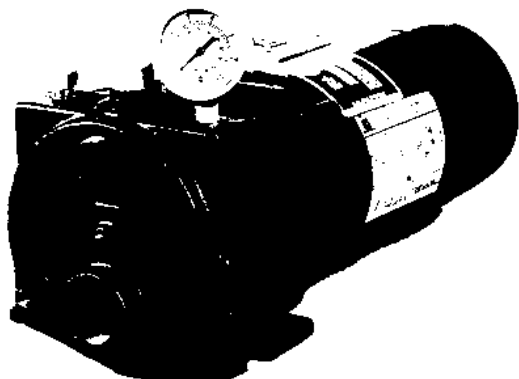

NRTL/C
CSA 108
UL 778

Model	HP	A
5RP2	1/2	14-3/8
7RP2	3/4	15-3/8

Dimensions

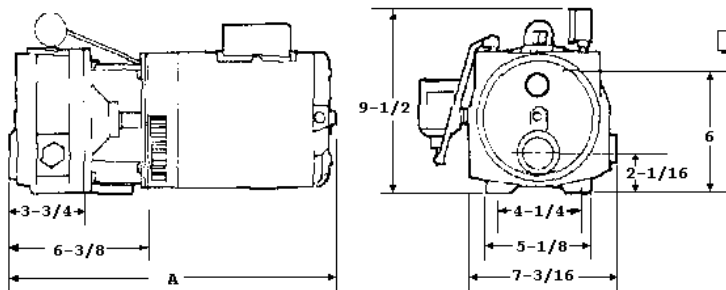

Note: Dimensions may vary according to motor manufacturer.

Single Stage Convertible Jet Pumps.

The RP2 pumps up to 20 gallons per minute in a shallow well and up to 13 gallons per minute in deep wells. Available in 1/2 and 3/4 HP.

Features:

- ❑ **Heavy-duty cast iron construction** for long life
- ❑ **Thermoplastic impeller and diffuser** for increased efficiency
- ❑ **Cast-iron case** will handle booster pump applications up to 150 PSI
- ❑ **Shaft coupling** designed for easy removal of pump motor.
- ❑ **Mechanical shaft seal** ensures leakproof fit.
- ❑ **High service factor 56C-frame motors** for maximum performance.
- ❑ **"Convertible"** Hardware includes pressure gauge, plugs, by-pass plug, and shallow well injector (screw-in injector allows easy conversion from shallow to deep well installation.)
- ❑ **Adjustable pressure switch** is factory-installed at 20/40 PSI.
- ❑ **Connections**
 - 1-1/4" FNPT Suction
 - 1" FNPT Discharge
 - 1" FNPT Drive Line

RP2 Series Convertible Jet Pumps

RP2 CONVERTIBLE JET PUMPS

Model	HP	Discharge x Suction	Voltage	PUMP UNIT	DEEP WELL INJECTOR	
				Order No.	Suction Lift	Order No.
5RP2C	1/2	1" x 1-1/4"	115/230	91021626	30 - 60 Ft.	147E0919
					60 - 90 Ft.	147E1018
7RP2C	3/4	1" x 1-1/4"	115/230	91021634	30 - 60 Ft.	147E1123
					60 - 90 Ft.	147E1118

Hardware kit provided with each pump includes: Screw-in shallow well injector, bypass plug, pressure gauge, pipe plugs.
Pressure switch is factory installed and preset to 20-40 PSI. Order deep well injector separately.

Optional Injector for RP2 High Head Performance

Model No.	HP	Injector Ordering No.
7RP2	3/4	18-1247-01-R

Pressure Gauge

Ordering No.	Pressure Reading
9193-4018-R	0 - 100 PSI

Required for Deep Well Installations:



Parallel Pipe Injectors

Parallel Pipe Injector - Footvalve Combinations Cast Iron

Pump Model	Injector Ordering No. 30 - 60 Ft. Lift	Injector Ordering No. 60 - 90 Ft. Lift
5RM2	147E-1120	147E-0915
7RM2	147E-1023	147E-1118
1RM2	147E-1125	147E-1120

Notes:

- 1) 1 1/4" FNPT suction connection and 1" FNPT drive pipe connection.
- 2) Minimum inside well diameter requirement of 4".



RP2 Series

"The Most Trusted Name In Water"

Jet Pumps

Shallow Well Performance

RP2 1" Discharge x 1-1/4" Suction			Discharge Pressure - PSI									Shut-off Pressure PSI
Model	Injector Order No.	Total Suction Lift Feet	30	35	40	45	50	55	60	65	70	
			Gallons per Minute									
5RP2 1/2 HP	18-1247-01	5	13	12.5	11.5	10	7.5	5.5	3.5	1.5		69
		10	11.5	11	10	8.5	6.5	4.5	2.5			67
		15	10	9.5	9	7.5	5.5	3.5	1.5			64
		20	8	8	7.5	6.5	4.5	2.5				62
		25	6	6	5.5	5	3.5	1.5				
7RP2 3/4 HP	18-1248-00	5	20	18.5	16	12.5	8	1.5				56
		10	17.5	16.5	14	10	4					52
		15	16	15	12	8						50
		20	13	12	10	4						47
		25		9.5	7							
High Head 7RP2 3/4 HP	18-1247-01	5		12	12	12	11	9	7	5	2.5	76
		10		11	10.5	10.5	10	8	6	4	1.5	74
		15		9.5	9	9	9	7	5	3		71
		20		8	8	7.5	7.5	6	4	2		69
		25		6.5	6.5	6	6	5	3	1		67

- Notes:**
- 1) The appropriate injector is included with the units.
 - 2) All the above discharge pressures were measured using 1 1/4" PVC suction pipe and 1 1/4" footvalve.

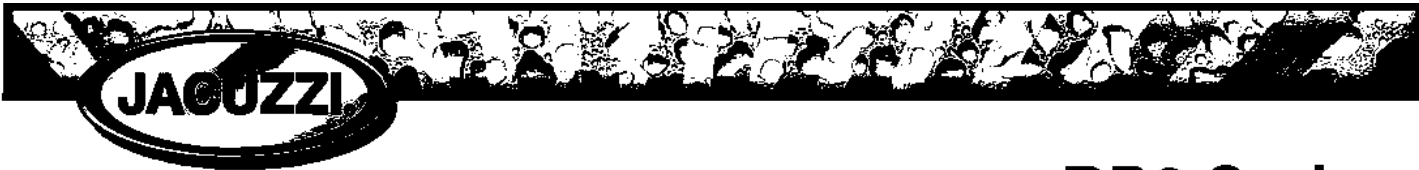

RP2 Series

Jet Pumps

Deep Well Performance

RP2 1" Disch. x 1-1/4" Suct., 1" Drive Pipe			Discharge Pressure - PSI								Shut-off Pressure PSI	Inj. Min. Operating Pressure
Model No.	Injector Order No.	Total Suction Lift Feet	30	35	40	45	50	55	60	65		
			Gallons per Minute									
5RP2 1/2 HP	Cast Iron 147E-0919	30	8.5	7	5.5	4.5	3.0	2.0	1.0		66	20
		40	7.0	6	4.5	3.5	2.0	1.0			62	
		50	6.0	5	3.5	2	1.0				57	
		60	5.0	3.5	2.5	1.5					53	
5RP2 1/2 HP	Cast Iron 147E-1018	60	6.0	5.0	4.0	3.0	2.0	1.0			66	23
		70	5.0	4.0	3.0	2.0	1.5				62	
		80	4.0	3.0	2.0	1.5					56	
		90	3.0	2.0	1.5						51	
7RP2 3/4 HP	Cast Iron 147E-1123	30	12.0	10	8.5	6.5	5.0	3.0			62	28
		40	10.0	8.5	7.0	5.0	3.0	1.0			58	
		50	8.5	7.0	5.0	3.0	1.0				54	
		60	6.5	5.0	3.0	1.5					49	
7RP2 3/4 HP	Cast Iron 147E-1118	60	7.5	6.5	6	5.0	4.0	3.0	2.5	1.5	75	30
		70	7.0	6.0	5	4.0	3.0	2.0	1.0		69	
		80	5.5	4.0	3.5	2.5	2.0	1.0			64	
		90	4.5	3.5	2.5	2.0	1.0				57	

Notes: 1) Deep well injectors must be ordered separately.
 2) All the above discharge pressures were measured using 1 1/4" PVC suction pipe and 1 1/4" foot valve and 1" drive pipe.