

RATCHET TOOL INSTRUCTIONS AND CARE

The Ratchet Tool will assemble all sizes of clamps. To assure proper assembly, all components should be of the same manufacturer.

Assembly of Connection

Cut the tube so that a clean, straight end is provided. Slide the clamp over the tube end. Insert a fitting into the tube end making sure that the tube is fully seated over the insert barb. The clamp may now be positioned so that it is 1/8" to 1/4" from the tubings cut end.

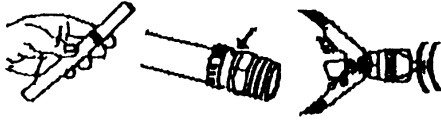

- 1) Slide the clamp over the tubing.
- 2) Slide the tubing onto the insert fitting.
- 3) Close the clamp with the Ratchet Tool.

Place the opened jaws of the Ratchet Tool over the raised ear of the clamp. Check to be sure that the clamp is still properly positioned, then begin to compress the tool handles. Proceed until a first "click" is felt. The clamp is now locked perpendicular to the tubing. The tool handles can now be compressed together to complete the assembly. Note: The Ratchet Tool will not release until the assembly is completed.

Removal of a Completed Connection

If required, clamps may be removed as follows:



- 1) Place a flat bladed screwdriver under the clamp lip and push up to unlock.
- 2) Using the clamp removal piece tool, grab onto the tab and pull. The clamp should now snap free.

Note: After removal of the clamp, the previously clamped section of the tube should be cut off prior to assembly of a new connection. Tool will not release until the assembly is completed.

Tool Care

The Ratchet tool has been designed to provide years of trouble free service. Failure to provide basic tool care and maintenance will however cause excess wear and possible premature failure. The following should be adhered to in order to maintain proper tool operation and Warranty coverage.

- Do not use the ratchet tool for any purpose other than to assemble clamps. Use other than intended may damage the tool and void Warranty coverage.
- Lubricate the tool head, spring and ratchet mechanism once per 30 days with a light lubricating oil (if tool operation becomes sluggish at any time lubricate prior to further use).
- Clean tool periodically to remove rust and dirt. Rust or dirt build-up will interfere with tool operation and void Warranty coverage. Lubricate all parts after cleaning to provide a light protective coating of oil.

Warranty Information

When properly maintained and used as intended the Ratchet Tool is warranted against materials and manufacturing defects for a period of 1 year from date of purchase. This Warranty does not cover defects or damage arising from improper installation, lack of or improper maintenance, improper storage or handling, ordinary wear and tear, misuse, abuse, accident or use with unauthorized products or parts. Liability is limited to repair or replacement of product or component part which is determined defective as covered by this Warranty. This limited Warranty provides specific legal rights. Some states do not allow the limitation or exclusion of damage so that actual rights may vary state to state.

Parts Diagram

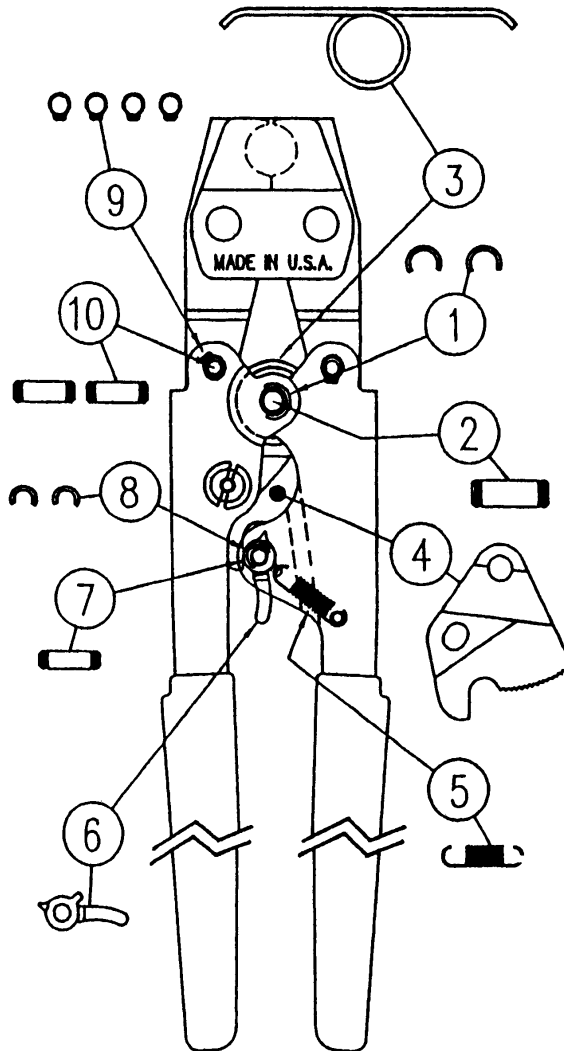

Item	Part #	Description	Qty
1	2000-25	Retaining ring	2
2	2 P 10	Pivot Pin	1
3	4 S 36	Torsion Spring	1
4	SP 2041-17	Ratchet	1
5	2 S 8	Pawl Spring	1
6	35-117	Pawl/Lever	6
7	2 P 11	Pawl Pivot Pin	1
8	2000-15	Retaining Ring	2
9	3100-18	Retaining Ring	4
10	2 P 5	Handle Pin	2